



# General power applications, switching functions, power/dimming signals and low voltage

## Application example



## General

Four variations are available for the 5-pole connectors: the standard version for general power applications, another version for switching functions, a version to combine power and dimming signals, as well as a version for low-voltage applications.

All connectors are mechanically coded. This means that only associated pairs of male and female can be connected with the correct polarity. You therefore have the security of a clear separation of different applications without having to redo any incorrect connections. The color of the connectors indicates the links that belong together.

## Coding

For daily updates visit the website at <a href="http://eshop.wieland-electric.com">http://eshop.wieland-electric.com</a> . Assembly instructions and other technical information can be found in the Technical Data or in eShop.					Application					
Mechanical coding, for example					Power 250V/400V	Extra-low voltage	Power 250V + Dimming	Switch. func. 250 V	Power 250/400V without	
					⊕ N, 3, 2, 1	1,2,3,4,5	L, N, ⊕, D1, D2	1,2,3/N, 4,5	N,E,1,2,3	
Name	Description	Connection style	Strain relief housing	Connection points per pole	light gray	black	signal brown	turquoise	light blue	yellow
Connector	1 x cable entry	Screw Crimp	yes	1	✓	✓	✓	✓	✓	✓
	2 x cable entry	Screw Spring clamp	yes	1	✓	✓	✓	✓	✓	✓
Distribution units	RST compact distribution unit/ multi-distribution unit				on request	on request	on request	on request	on request	on request
	Individual distribution box				on request	on request	on request	on request	on request	on request
Device connectors	M16 device connector, modular, straight				✓	✓	✓	✓	✓	
	M16 device connector, modular, angled 7°				✓	✓	✓	✓	✓	
	M25 device connector, standard				✓	✓	✓	✓	✓	✓
	M20 device connector, standard				✓	✓	✓	✓	✓	
	M20 device connector, modular, angled				✓	✓	✓	✓	✓	
	M25 device connector, modular, angled				✓	✓	✓	✓	✓	
Cable assemblies	Connection cable Male – Free end	pre-assembled	pre-assembled	pre-assembled	✓	✓	✓	✓	✓	
	Connection cable Female – Free end	pre-assembled	pre-assembled	pre-assembled	✓	✓	✓	✓	✓	
	Extension cable Male – Female	pre-assembled	pre-assembled	pre-assembled	✓	✓	✓	✓	✓	
	Extension cable Male – Female	pre-assembled	pre-assembled	pre-assembled	✓	✓	✓	✓	✓	

# Connectors, straight for cables Ø 6 – 10 mm and 10 – 14 mm

## Female connector

Unmounted with cable gland.

Crimp contacts separately available under Accessories.

See the Technical Data for sheath and insulation strip lengths.

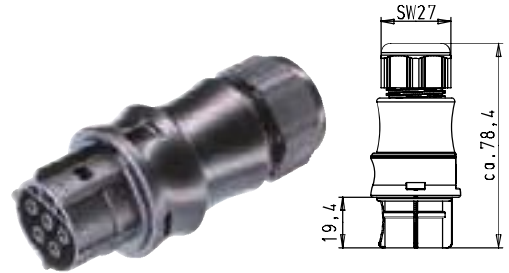
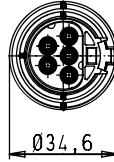

### with screw connection<sup>1)</sup>

Wire	mm <sup>2</sup>
rigid	
fine-stranded	0.75 – 4.0
stranded	without ferrules

### with crimp connection

Wire	mm <sup>2</sup>
fine-stranded	0.75 – 4.0

Application	Coding	Cable diameter in mm	Color
Power 250/400V		6 – 10	gray black
		10 – 14	gray black
Power 250V +Dimming		6 – 10	turquoise
		10 – 14	
Switch.func. 250V		6 – 10	light blue
		10 – 14	
Extra-low voltage		6 – 10	signal
		10 – 14	brown
Power 250/400V o.		6 – 10	yellow

Part No.	Part No.
96.051.4053.0	96.151.0053.0
96.051.4053.1	96.151.0053.1
96.051.4153.0	96.151.0153.0
96.051.4153.1	96.151.0153.1
96.051.4053.6	96.151.0053.6
96.051.4153.6	96.151.0153.6
96.051.4053.9	96.151.0053.9
96.051.4153.9	96.151.0153.9
96.051.4051.4	96.151.0051.4
96.051.4151.4	96.151.0151.4
96.051.4053.2	96.151.0151.4

Contacts separately under Accessories, see following pages.

## Male connector

Unmounted with cable gland and locking device.

Crimp contacts separately available under Accessories.

See the Technical Data for sheath and insulation strip lengths.

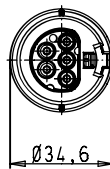

### with screw connection<sup>1)</sup>

Wire	mm <sup>2</sup>
rigid	
fine-stranded	0.75 – 4.0
stranded	without ferrules
Locking device	yes

### with crimp connection

Wire	mm <sup>2</sup>
fine-stranded	0.75 – 4.0
Locking device	yes

Application	Coding	Cable diameter in mm	Color
Power 250/400V		6 – 10	gray black
		10 – 14	gray black
Power 250V +Dimming		6 – 10	turquoise
		10 – 14	
Schaltfunk. 250V		6 – 10	light blue
		10 – 14	
Extra-low voltage		6 – 10	signal
		10 – 14	brown
Power 250/400V o.		6 – 10	yellow

Part No.	Part No.
96.052.4053.0	96.152.0053.0
96.052.4053.1	96.152.0053.1
96.052.4153.0	96.152.0153.0
96.052.4153.1	96.152.0153.1
96.052.4053.6	96.152.0053.6
96.052.4153.6	96.152.0153.6
96.052.4053.9	96.152.0053.9
96.052.4153.9	96.152.0153.9
96.052.4051.4	96.152.0051.4
96.052.4151.4	96.152.0151.4
96.052.4053.2	96.152.0151.4

Contacts separately under Accessories, see following pages.

<sup>1)</sup> With wire protection available on request

# Connectors, angled 90° for cables Ø 6 – 10 mm and 10 – 14 mm

## Female connector

Unmounted with cable gland.  
90° angle.

See the Technical Data for sheath and insulation strip length as well as the ferrules to be used.

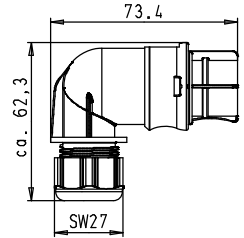
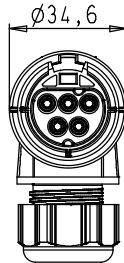

### with screw connection<sup>1)</sup>

Wire	mm <sup>2</sup>
rigid	
fine-stranded	0.75 – 4.0
stranded	without ferrules

### with crimp connection

Wire	mm <sup>2</sup>
fine-stranded	0.75 – 4.0

Application	Coding	Cable diameter in mm	Color
Power 250/400V	⊕, N, 3, 2, 1	6 – 10	gray black
		10 – 14	gray black
Power 250V +Dimming	L, ⊕, N, D1, D2	6 – 10 10 – 14	turquoise
Switch.func. 250V	1, 2, 3/N, 4, 5	6 – 10 10 – 14	light blue
Extra-low voltage	1, 2, 3, 4, 5	6 – 10	signal
		10 – 14	brown

Part No.
96.053.4053.0
96.053.4053.1
96.053.4153.0
96.053.4153.1
96.053.4053.6
96.053.4153.6
96.053.4053.9
96.053.4153.9
96.053.4051.4
96.053.4151.4

Part No.
96.153.0053.0
96.153.0053.1
96.153.0153.0
96.153.0153.1
96.153.0053.6
96.153.0153.6
96.153.0053.9
96.153.0153.9
96.153.0051.4
96.153.0151.4

Contacts separately under Accessories, see following pages.

## Male connector

Unmounted with cable gland and locking device.  
90° angle.

See the Technical Data for sheath and insulation strip length as well as the ferrules to be used.

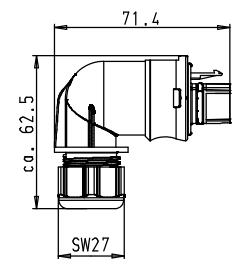
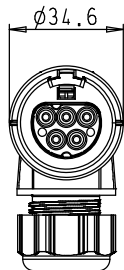

### with screw connection<sup>1)</sup>

Wire	mm <sup>2</sup>
rigid	
fine-stranded	0.75 – 4.0
stranded	without ferrules
Locking device	yes

### with crimp connection

Wire	mm <sup>2</sup>
fine-stranded	0.75 – 4.0
Locking device	yes

Application	Coding	Cable diameter in mm	Color
Power 250/400V	⊕, N, 3, 2, 1	6 – 10	gray black
		10 – 14	gray black
Power 250V +Dimming	L, ⊕, N, D1, D2	6 – 10 10 – 14	turquoise
Switch.func. 250V	1, 2, 3/N, 4, 5	6 – 10 10 – 14	light blue
Extra-low voltage	1, 2, 3, 4, 5	6 – 10	signal
		10 – 14	brown

Part No.
96.054.4053.0
96.054.4053.1
96.054.4153.0
96.054.4153.1
96.054.4053.6
96.054.4153.6
96.054.4053.9
96.054.4153.9
96.054.4051.4
96.054.4151.4

Part No.
96.154.0053.0
96.154.0053.1
96.154.0153.0
96.154.0153.1
96.154.0053.6
96.154.0153.6
96.154.0053.9
96.154.0153.9
96.154.0051.4
96.154.0151.4

Contacts separately under Accessories, see following pages.

<sup>1)</sup> With wire protection available on request

# Connectors, straight for cable Ø 13 – 18 mm

## Female connector

Unmounted with cable gland.

Crimp contacts separately available under Accessories.

See the Technical Data for sheath and insulation strip lengths.

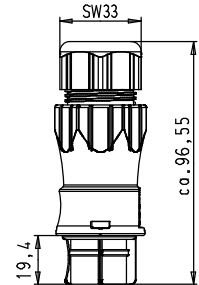
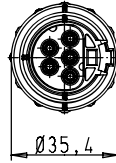





### with screw connection<sup>1)</sup>

Wire	mm <sup>2</sup>
rigid	
fine-stranded	0.75 – 4.0
stranded	without ferrules

### with crimp connection

Wire	mm <sup>2</sup>
fine-stranded	0.75 – 4.0

Application	Coding	Cable diameter in mm	Color
Power 250/400V	 ⊕, N, 3, 2, 1	6 – 10	gray black
		10 – 14	gray black
Power 250V +Dimming	 L, ⊕, N, D1, D2	6 – 10 10 – 14	turquoise
Switch.func. 250V	 1, 2, 3/N, 4, 5	6 – 10	light blue
		10 – 14	
Extra-low voltage	 1, 2, 3, 4, 5	6 – 10	signal brown
		10 – 14	

Part No.	Part No.
96.051.4553.0	96.151.0553.0
96.051.4553.1	96.151.0553.1
96.051.4553.6	96.151.0553.6
96.051.4553.9	96.151.0553.9
96.051.4551.4	96.151.0551.4

Contacts separately under Accessories, see following pages.

## Male connector

Unmounted with cable gland and locking device.  
Crimp contacts separately available under Accessories.

See the Technical Data for sheath and insulation strip lengths.

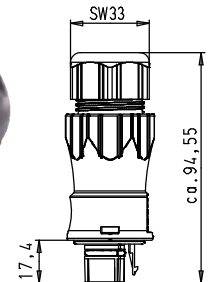
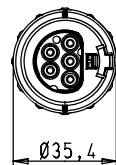





### with screw connection<sup>1)</sup>

Wire	mm <sup>2</sup>
rigid	
fine-stranded	0.75 – 4.0
stranded	without ferrules
Locking device	yes

### with crimp connection

Wire	mm <sup>2</sup>
fine-stranded	0.75 – 4.0
Locking device	yes

Application	Coding	Cable diameter in mm	Color
Power 250/400V	 ⊕, N, 3, 2, 1	6 – 10	gray black
		10 – 14	gray black
Power 250V +Dimming	 L, ⊕, N, D1, D2	6 – 10 10 – 14	turquoise
Switch.func. 250V	 1, 2, 3/N, 4, 5	6 – 10	light blue
		10 – 14	
Extra-low voltage	 1, 2, 3, 4, 5	6 – 10	signal brown
		10 – 14	

Part No.	Part No.
96.052.4553.0	96.152.0553.0
96.052.4553.1	96.152.0553.1
96.052.4553.6	96.152.0553.6
96.052.4553.9	96.152.0553.9
96.052.4551.4	96.152.0551.4

Contacts separately under Accessories, see following pages.

<sup>1)</sup> With wire protection available on request

# Splitter connector, straight for cables Ø 6 – 10 mm and 10 – 14 mm

## Female connector

Unmounted with cable glands.

See Technical Data for sheath and insulation strip lengths.

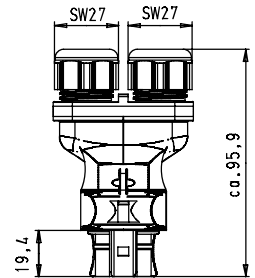
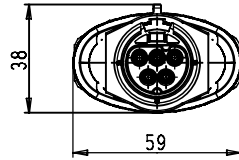

### with screw connection<sup>1)</sup>

Wire	mm <sup>2</sup>
rigid	
fine-stranded	0.75 – 1.5
stranded	without ferrules

Application	Coding	Cable diameter in mm	Color	Part No.	
Power 250/400V		⊕, N, 3, 2, 1	6 – 10	gray	96.051.4253.0
			10 – 14	black	96.051.4253.1
Power 250V +Dimming		L, ⊕, N, D1, D2	6 – 10	gray	96.051.4353.0
			10 – 14	black	96.051.4353.1
Switch.func. 250V		1, 2, 3/N, 4, 5	6 – 10	turquoise	96.051.4253.6
			10 – 14	turquoise	96.051.4353.6
Extra-low voltage		1, 2, 3, 4, 5	6 – 10	light blue	96.051.4251.4
			10 – 14	light blue	96.051.4351.4

## Mounting plate for splitter connectors

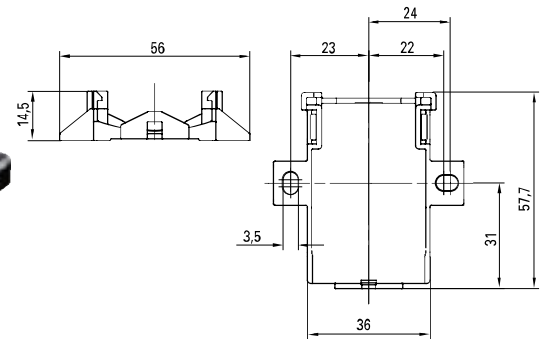

Color	Part No.
gray	01.006.1553.0
black	01.006.1553.1

<sup>1)</sup> With wire protection available on request

# M25 device connector straight, standard

## Female connector

Correct positioning guaranteed due to flattened thread. Fastening with screws from outside.

Crimp contacts separately available under Accessories.  
See the Technical Data for insulation strip lengths.  
For spacer rings for unlocking the device connector, see Accessories.

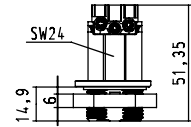
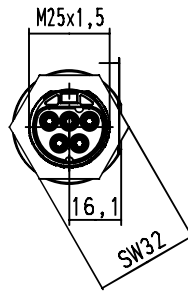

wahlweise Verdrehsicherung  
optional protection against twisting

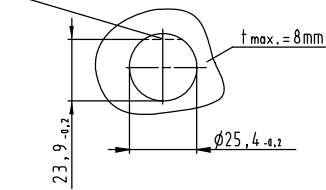

### with screw connection

Wire	mm <sup>2</sup>
rigid	
fine-stranded	0.75 – 4.0
stranded	without ferrules
Term. poles	1
Thread	M25 x 1.5
Gland	outside

### with crimp connection

Wire	mm <sup>2</sup>
fine-stranded	0.75 – 4.0
Term. poles	1
Thread	M25 x 1.5
Gland	outside

Contacts separately under Accessories, see following pages.

Application	Coding	Color
Power 250/400V	⊕, N, 3, 2, 1	gray black
Power 250V +Dimming	L, ⊕, N, D1, D2	turquoise
Switch.func. 250V	1, 2, 3/N, 4, 5	light blue
Extra-low voltage	1, 2, 3, 4, 5	signal brown
Power 250/400V a. ⊕	N, E, 1, 2, 3	yellow

Part No.
96.051.5053.0
96.051.5053.1
96.051.5053.6
96.051.5053.9
96.051.5051.4

Part No.
96.151.1053.0
96.151.1053.1
96.151.1053.6
96.151.1053.9
96.151.1051.4
96.151.1053.2

## Male connector

Correct positioning guaranteed due to flattened thread. With locking device.  
Fastening with screws from outside.

Crimp contacts separately available under Accessories.

See the Technical Data for insulation strip lengths.

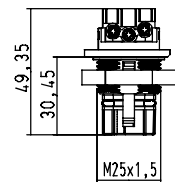
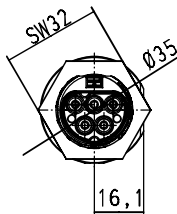

wahlweise Verdrehsicherung  
optional protection against twisting

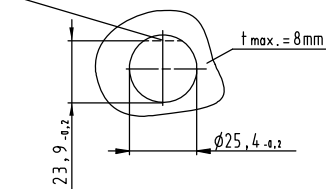

### with screw connection

Wire	mm <sup>2</sup>
rigid	
fine-stranded	0.75 – 4.0
stranded	without ferrules
Term. poles	1
Thread	M25 x 1.5
Gland	outside
Locking device	yes

### with crimp connection

Wire	mm <sup>2</sup>
fine-stranded	0.75 – 4.0
Term. poles	1
Thread	M25 x 1.5
Gland	outside
Locking device	yes

Contacts separately under Accessories, see following pages.

Application	Coding	Color
Power 250/400V	⊕, N, 3, 2, 1	gray black
Power 250V +Dimming	L, ⊕, N, D1, D2	turquoise
Switch.func. 250V	1, 2, 3/N, 4, 5	light blue
Extra-low voltage	1, 2, 3, 4, 5	signal brown
Power 250/400V a. ⊕	N, E, 1, 2, 3	yellow

Part No.
96.052.5053.0
96.052.5053.1
96.052.5053.6
96.052.5053.9
96.052.5051.4

Part No.
96.152.1053.0
96.152.1053.1
96.152.1053.6
96.152.1053.9
96.152.1051.4
96.152.1053.2

# M20 device connector straight, modular

## Female connector

Correct positioning guaranteed due to flattened thread. Fastening with screws from inside.

Crimp contacts separately available under Accessories.

See the Technical Data for sheath and insulation strip lengths.

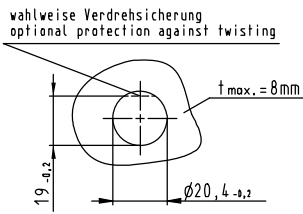
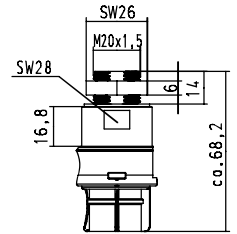

### with screw connection

Wire	mm <sup>2</sup>
rigid	
fine-stranded	0.75 – 4.0
stranded	without ferrules
Term. poles	1
Thread	M20 x 1.5
Gland	inside

### with crimp connection

Wire	mm <sup>2</sup>
fine-stranded	0.75 – 4.0
Term. poles	1
Thread	M20 x 1.5
Gland	inside

Application	Coding	Color
Power 250/400V	⊕, N, 3, 2, 1	gray black
Power 250V +Dimming	L, ⊕, N, D1, D2	turquoise
Switch.func. 250V	1, 2, 3/N, 4, 5	light blue
Extra-low voltage	1, 2, 3, 4, 5	signal brown

Part No.
96.051.6053.0
96.051.6053.1
96.051.6053.6
96.051.6053.9
96.051.6051.4

Part No.
96.151.2053.0
96.151.2053.1
96.151.2053.6
96.151.2053.9
96.151.2051.4

Contacts separately under Accessories, see following pages.

## Male connector

Correct positioning guaranteed due to flattened thread. With locking device. Fastening with screws from inside.

Crimp contacts separately available under Accessories.

See the Technical Data for sheath and insulation strip lengths.

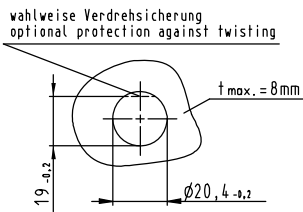
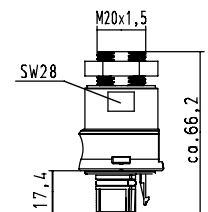
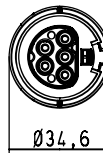

### with screw connection

Wire	mm <sup>2</sup>
rigid	
fine-stranded	0.75 – 4.0
stranded	without ferrules
Term. poles	1
Thread	M20 x 1.5
Gland	inside
Locking device	yes

### with crimp connection

Wire	mm <sup>2</sup>
fine-stranded	0.75 – 4.0
Term. poles	1
Thread	M20 x 1.5
Gland	inside
Locking device	yes

Application	Coding	Color
Power 250/400V	⊕, N, 3, 2, 1	gray black
Power 250V +Dimming	L, ⊕, N, D1, D2	turquoise
Switch.func. 250V	1, 2, 3/N, 4, 5	light blue
Extra-low voltage	1, 2, 3, 4, 5	signal brown

Part No.
96.052.6053.0
96.052.6053.1
96.052.6053.6
96.052.6053.9
96.052.6051.4

Part No.
96.152.2053.0
96.152.2053.1
96.152.2053.6
96.152.2053.9
96.152.2051.4

Contacts separately under Accessories, see following pages.



# M16 device connector straight, modular

## Female connector

Correct positioning guaranteed due to flattened thread. Fastening with screws from inside.

Crimp contacts separately available under Accessories.

See the Technical Data for insulation strip lengths.

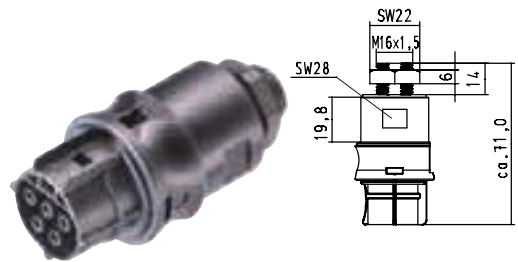

wahlweise Verdrehsicherung  
optional protection against twisting

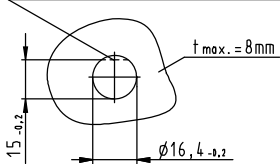

### with screw connection

Wire	mm <sup>2</sup>
rigid	
fine-stranded	0.75 – 4.0
stranded	without ferrules
Term. poles	1
Thread	M16 x 1.5
Gland	inside

### with crimp connection

Wire	mm <sup>2</sup>
fine-stranded	0.75 – 4.0
Term. poles	1
Thread	M16 x 1.5
Gland	inside

Application	Coding	Color
Power 250/400V	⊕, N, 3, 2, 1	gray black
Power 250V +Dimming	L, ⊕, N, D1, D2	turquoise
Switch.func. 250V	1, 2, 3/N, 4, 5	light blue
Extra-low voltage	1, 2, 3, 4, 5	signal brown

Part No.
96.051.6153.0
96.051.6153.1
96.051.6153.6
96.051.6153.9
96.051.6151.4

Part No.
96.151.2153.0
96.151.2153.1
96.151.2153.6
96.151.2153.9
96.151.2151.4

Contacts separately under Accessories, see following pages.

## Male connector

Correct positioning guaranteed due to flattened thread. With locking device. Fastening with screws from inside.

Crimp contacts separately available under Accessories.

See the Technical Data for insulation strip lengths.

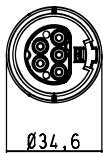

wahlweise Verdrehsicherung  
optional protection against twisting

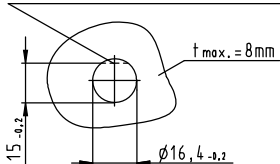

### with screw connection

Wire	mm <sup>2</sup>
rigid	
fine-stranded	0.75 – 4.0
stranded	without ferrules
Term. poles	1
Thread	M16 x 1.5
Gland	inside
Locking device	yes

### with crimp connection

Wire	mm <sup>2</sup>
fine-stranded	0.75 – 4.0
Term. poles	1
Thread	M16 x 1.5
Gland	inside
Locking device	yes

Application	Coding	Color
Power 250/400V	⊕, N, 3, 2, 1	gray black
Power 250V +Dimming	L, ⊕, N, D1, D2	turquoise
Switch.func. 250V	1, 2, 3/N, 4, 5	light blue
Extra-low voltage	1, 2, 3, 4, 5	signal brown

Part No.
96.052.6153.0
96.052.6153.1
96.052.6153.6
96.052.6153.9
96.052.6151.4

Part No.
96.152.2153.0
96.152.2153.1
96.152.2153.6
96.152.2153.9
96.152.2151.4

Contacts separately under Accessories, see following pages.

# M16 device connector angled 7°, modular

## Female connector

Correct positioning guaranteed due to flattened thread. Fastening with screws from inside. Angled 7°, thread M16.

Crimp contacts separately available under Accessories.

See the Technical Data for insulation strip lengths.

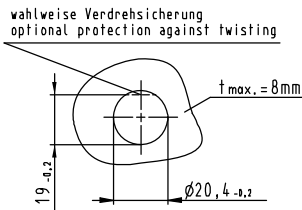
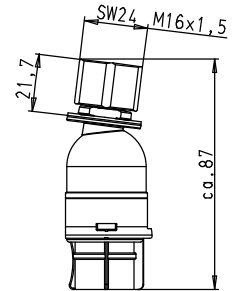

### with screw connection

Wire	mm <sup>2</sup>
rigid	
fine-stranded	0.75 – 4.0
stranded	without ferrules
Term. poles	1
Thread	M16 x 1.5
Gland	inside

### with crimp connection

Wire	mm <sup>2</sup>
fine-stranded	0.75 – 4.0
Term. poles	1
Thread	M16 x 1.5
Gland	inside

Application	Coding	Color
Power 250/400V	⊕, N, 3, 2, 1	gray black
Power 250V +Dimming	L, ⊕, N, D1, D2	turquoise
Switch.func. 250V	1, 2, 3/N, 4, 5	light blue
Extra-low voltage	1, 2, 3, 4, 5	signal brown

Part No.
96.055.6153.0
96.055.6153.1
96.055.6153.6
96.055.6153.9
96.055.6151.4

Part No.
96.155.2153.0
96.155.2153.1
96.155.2153.6
96.155.2153.9
96.155.2151.4

Contacts separately under Accessories, see following pages.

## Male connector

Correct positioning guaranteed due to flattened thread. With locking device. Fastening with screws from inside. Angled 7°, thread M16.

Crimp contacts separately available under Accessories.

See the Technical Data for insulation strip lengths.

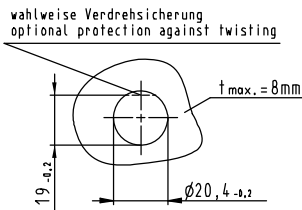
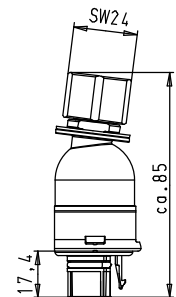
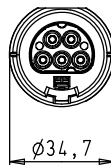

### with screw connection

Wire	mm <sup>2</sup>
rigid	
fine-stranded	0.75 – 4.0
stranded	without ferrules
Term. poles	1
Thread	M16 x 1.5
Gland	inside
Locking device	yes

### with crimp connection

Wire	mm <sup>2</sup>
fine-stranded	0.75 – 4.0
Term. poles	1
Thread	M16 x 1.5
Gland	inside
Locking device	yes

Application	Coding	Color
Power 250/400V	⊕, N, 3, 2, 1	gray black
Power 250V +Dimming	L, ⊕, N, D1, D2	turquoise
Switch.func. 250V	1, 2, 3/N, 4, 5	light blue
Extra-low voltage	1, 2, 3, 4, 5	signal brown

Part No.
96.056.6153.0
96.056.6153.1
96.056.6153.6
96.056.6153.9
96.056.6151.4

Part No.
96.156.2153.0
96.156.2153.1
96.156.2153.6
96.156.2153.9
96.156.2151.4

Contacts separately under Accessories, see following pages.

# M20 device connector angled 90°, modular

## Female connector

Correct positioning guaranteed due to flattened thread. Fastening with screws from inside. Angled 90°, thread M20.

Crimp contacts separately available under Accessories.

See the Technical Data for insulation strip lengths.

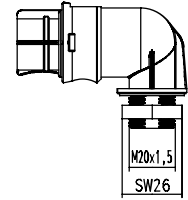
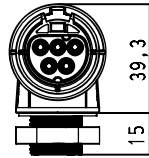

wahlweise Verdrehsicherung  
optional protection against twisting

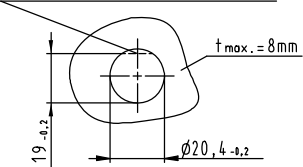

### with screw connection

Wire	mm <sup>2</sup>
rigid	
fine-stranded	0.75 – 4.0
stranded	without ferrules
Term. poles	1
Thread	M20 x 1.5
Gland	inside

### with crimp connection

Wire	mm <sup>2</sup>
fine-stranded	0.75 – 4.0
Term. poles	1
Thread	M20 x 1.5
Gland	inside

Application	Coding	Color
Power 250/400V	⊕, N, 3, 2, 1	gray black
Power 250V +Dimming	L, ⊕, N, D1, D2	turquoise
Switch.func. 250V	1, 2, 3/N, 4, 5	light blue
Extra-low voltage	1, 2, 3, 4, 5	signal brown

Part No.
96.053.6053.0
96.053.6053.1
96.053.6053.6
96.053.6053.9
96.053.6051.4

Part No.
96.153.2053.0
96.153.2053.1
96.153.2053.6
96.153.2053.9
96.153.2051.4

Contacts separately under Accessories, see following pages.

## Male connector

Correct positioning guaranteed due to flattened thread. With locking device. Fastening with screws from inside. Angled 90°, thread M20.

Crimp contacts separately available under Accessories.

See the Technical Data for insulation strip lengths.

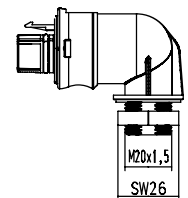
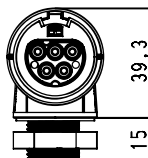

wahlweise Verdrehsicherung  
optional protection against twisting

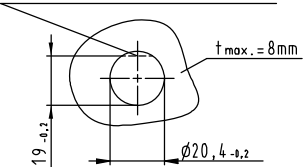

### with screw connection

Wire	mm <sup>2</sup>
rigid	
fine-stranded	0.75 – 4.0
stranded	without ferrules
Term. poles	1
Thread	M20 x 1.5
Gland	inside
Locking device	yes

### with crimp connection

Wire	mm <sup>2</sup>
fine-stranded	0.75 – 4.0
Term. poles	1
Thread	M20 x 1.5
Gland	inside
Locking device	yes

Application	Coding	Color
Power 250/400V	⊕, N, 3, 2, 1	gray black
Power 250V +Dimming	L, ⊕, N, D1, D2	turquoise
Switch.func. 250V	1, 2, 3/N, 4, 5	light blue
Extra-low voltage	1, 2, 3, 4, 5	signal brown

Part No.
96.054.6053.0
96.054.6053.1
96.054.6053.6
96.054.6053.9
96.054.6051.4

Part No.
96.154.2053.0
96.154.2053.1
96.154.2053.6
96.154.2053.9
96.154.2051.4

Contacts separately under Accessories, see following pages.

# M25 device connector angled 90°, modular

## Female connector

Correct positioning guaranteed due to flattened thread. Fastening with screws from inside. Angled 90°, thread M25.

Crimp contacts separately available under Accessories.

See the Technical Data for insulation strip lengths.

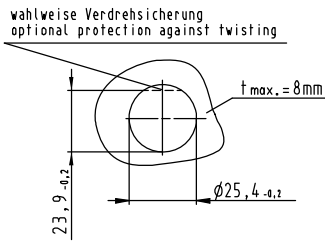
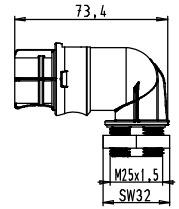
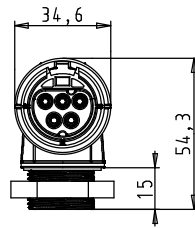

### with screw connection

Wire	mm <sup>2</sup>
rigid	
fine-stranded	0.75 – 4.0
stranded	without ferrules
Term. poles	1
Thread	M25 x 1.5
Gland	inside

### with crimp connection

Wire	mm <sup>2</sup>
fine-stranded	0.75 – 4.0
Term. poles	1
Thread	M25 x 1.5
Gland	inside

Application	Coding	Color
Power 250/400V	⊕, N, 3, 2, 1	gray black
Power 250V +Dimming	L, ⊕, N, D1, D2	turquoise
Switch.func. 250V	1, 2, 3/N, 4, 5	light blue
Extra-low voltage	1, 2, 3, 4, 5	signal brown

Part No.
96.053.6253.0
96.053.6253.1
96.053.6253.6
96.053.6253.9
96.053.6251.4

Part No.
96.153.2253.0
96.153.2253.1
96.153.2253.6
96.153.2253.9
96.153.2251.4

Contacts separately under Accessories, see following pages.

## Male connector

Correct positioning guaranteed due to flattened thread. With locking device. Fastening with screws from inside. Angled 90°, thread M25.

Crimp contacts separately available under Accessories.

See the Technical Data for insulation strip lengths.

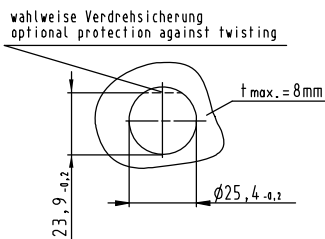
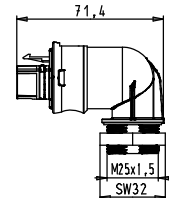
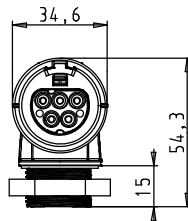

### with screw connection

Wire	mm <sup>2</sup>
rigid	
fine-stranded	0.75 – 4.0
stranded	without ferrules
Term. poles	1
Thread	M25 x 1.5
Gland	inside
Locking device	yes

### with crimp connection

Wire	mm <sup>2</sup>
fine-stranded	0.75 – 4.0
Term. poles	1
Thread	M25 x 1.5
Gland	inside
Locking device	yes

Application	Coding	Color
Power 250/400V	⊕, N, 3, 2, 1	gray black
Power 250V +Dimming	L, ⊕, N, D1, D2	turquoise
Switch.func. 250V	1, 2, 3/N, 4, 5	light blue
Extra-low voltage	1, 2, 3, 4, 5	signal brown

Part No.
96.054.6253.0
96.054.6253.1
96.054.6253.6
96.054.6253.9
96.054.6251.4

Part No.
96.154.2253.0
96.154.2253.1
96.154.2253.6
96.154.2253.9
96.154.2251.4

Contacts separately under Accessories, see following pages.

# Cable assemblies

## Cable 5 x 1.5 mm<sup>2</sup>; 16 A

Rated values		
Wire ends	(open cable end)	ultrason. welded
Sheath strip length	(open cable end)	35 mm
Wire strip length	(open cable end)	9 mm

Connection type cable	Cable gland
Lockable	yes, loosening with screw driver
Color cable	black
Color handle shell	black

### Connection cables female – male

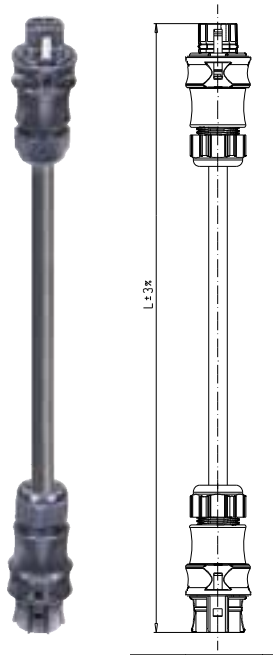

Cable	Length m	Part No.	
		Power 250V / 400V	Power 250V + Dimming
<b>PVC cable H05VV-F</b> containing halogen	1	96.452.1000.1	96.452.1000.6
	2	96.452.2000.1	96.452.2000.6
	3	96.452.3000.1	96.452.3000.6
	4	96.452.4000.1	96.452.4000.6
	5	96.452.5000.1	96.452.5000.6
	6	96.452.6000.1	96.452.6000.6
	7	96.452.7000.1	96.452.7000.6
	8	96.452.8000.1	96.452.8000.6

Cable	Length m	Part No.	
		Power 250V / 400V	Power 250V + Dimming
<b>Rubber-sheathed cable H07RN-F</b> containing halogen	1	96.452.1030.1	96.452.1031.6
	2	96.452.2030.1	96.452.2031.6
	3	96.452.3030.1	96.452.3031.6
	4	96.452.4030.1	96.452.4031.6
	5	96.452.5030.1	96.452.5031.6
	6	96.452.6030.1	96.452.6031.6
	7	96.452.7030.1	96.452.7031.6
	8	96.452.8030.1	96.452.8031.6

Cable	Length m	Part No.	
		Power 250V / 400V	Power 250V + Dimming
<b>Rubber-sheathed cable H07RN-F enhanced version</b> halogen-free	1	96.452.1050.1	
	2	96.452.2050.1	
	3	96.452.3050.1	
	4	96.452.4050.1	
	5	96.452.5050.1	
	6	96.452.6050.1	
	7	96.452.7050.1	
	8	96.452.8050.1	

### Connection cables female – free end

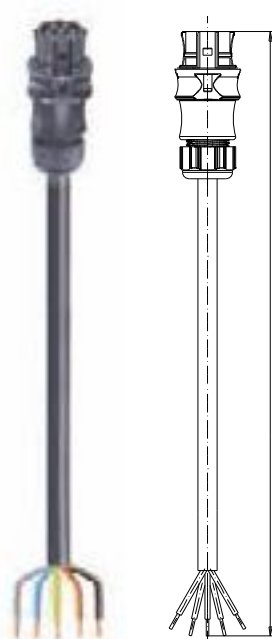

Cable	Length m	Part No.	
		Power 250V / 400V	Power 250V + Dimming
<b>PVC cable H05VV-F</b> containing halogen	1	96.452.1003.1	96.452.1003.6
	2	96.452.2003.1	96.452.2003.6
	3	96.452.3003.1	96.452.3003.6
	4	96.452.4003.1	96.452.4003.6
	5	96.452.5003.1	96.452.5003.6
	6	96.452.6003.1	96.452.6003.6
	7	96.452.7003.1	96.452.7003.6
	8	96.452.8003.1	96.452.8003.6

Cable	Length m	Part No.	
		Power 250V / 400V	Power 250V + Dimming
<b>Rubber-sheathed cable H07RN-F</b> containing halogen	1	96.452.1033.1	96.452.1033.6
	2	96.452.2033.1	96.452.2033.6
	3	96.452.3033.1	96.452.3033.6
	4	96.452.4033.1	96.452.4033.6
	5	96.452.5033.1	96.452.5033.6
	6	96.452.6033.1	96.452.6033.6
	7	96.452.7033.1	96.452.7033.6
	8	96.452.8033.1	96.452.8033.6

Cable	Length m	Part No.	
		Power 250V / 400V	Power 250V + Dimming
<b>Rubber-sheathed cable H07RN-F enhanced version</b> halogen-free	1	96.452.1053.1	
	2	96.452.2053.1	
	3	96.452.3053.1	
	4	96.452.4053.1	
	5	96.452.5053.1	
	6	96.452.6053.1	
	7	96.452.7053.1	
	8	96.452.8053.1	

Other cable lengths, other codings upon request

# Cable assemblies

## Cable 5 x 1.5 mm<sup>2</sup>; 16 A

### Connection cables male – free end

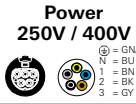
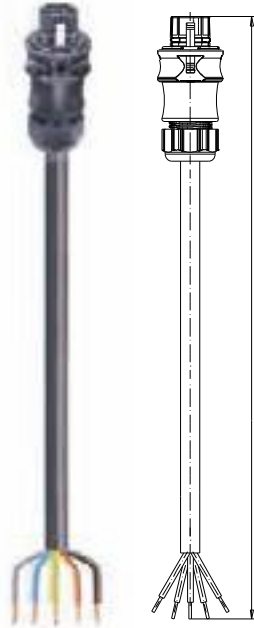

Cable	Length m	Part No.	Part No.
<b>PVC cable H05VV-F</b> containing halogen	1	96.452.1004.1	96.452.1004.6
	2	96.452.2004.1	96.452.2004.6
	3	96.452.3004.1	96.452.3004.6
	4	96.452.4004.1	96.452.4004.6
	5	96.452.5004.1	96.452.5004.6
	6	96.452.6004.1	96.452.6004.6
	7	96.452.7004.1	96.452.7004.6
	8	96.452.8004.1	96.452.8004.6

Cable	Length m	Part No.	Part No.
<b>Rubber-sheathed cable H07RN-F</b> containing halogen	1	96.452.1034.1	96.452.1034.6
	2	96.452.2034.1	96.452.2034.6
	3	96.452.3034.1	96.452.3034.6
	4	96.452.4034.1	96.452.4034.6
	5	96.452.5034.1	96.452.5034.6
	6	96.452.6034.1	96.452.6034.6
	7	96.452.7034.1	96.452.7034.6
	8	96.452.8034.1	96.452.8034.6

Cable	Length m	Part No.
<b>Rubber-sheathed cable H07RN-F enhanced version</b> halogen-free	1	96.452.1054.1
	2	96.452.2054.1
	3	96.452.3054.1
	4	96.452.4054.1
	5	96.452.5054.1
	6	96.452.6054.1
	7	96.452.7054.1
	8	96.452.8054.1

# Cable assemblies

## Cable 5 x 2.5 mm<sup>2</sup>; 20 A

Rated values		
Wire ends	(open cable end)	ultrason. welded
Sheath strip length	(open cable end)	35 mm
Wire strip length	(open cable end)	9 mm

Connection type cable	Cable gland
Lockable	yes, loosening with screw driver
Color cable	black
Color handle shell	black

### Connection cables female – male

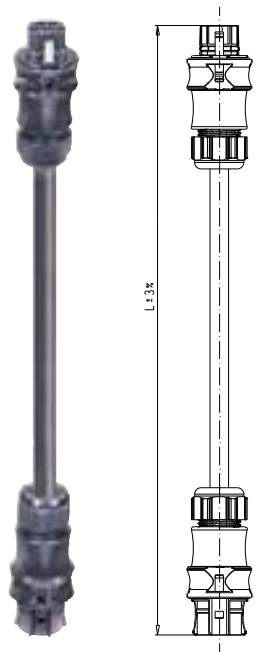

Power  
250V / 400V



Power 250V  
+ Dimming



Cable	Length m	Part No.	Part No.
<b>PVC cable H05VV-F</b> containing halogen	1	96.453.1000.1	96.453.1000.6
	2	96.453.2000.1	96.453.2000.6
	3	96.453.3000.1	96.453.3000.6
	4	96.453.4000.1	96.453.4000.6
	5	96.453.5000.1	96.453.5000.6
	6	96.453.6000.1	96.453.6000.6
	7	96.453.7000.1	96.453.7000.6
	8	96.453.8000.1	96.453.8000.6

Cable	Length m	Part No.	Part No.
<b>Rubber-sheathed cable H07RN-F</b> containing halogen	1	96.453.1030.1	96.453.1031.6
	2	96.453.2030.1	96.453.2031.6
	3	96.453.3030.1	96.453.3031.6
	4	96.453.4030.1	96.453.4031.6
	5	96.453.5030.1	96.453.5031.6
	6	96.453.6030.1	96.453.6031.6
	7	96.453.7030.1	96.453.7031.6
	8	96.453.8030.1	96.453.8031.6

Cable	Length m	Part No.
<b>Rubber-sheathed cable H07RN-F enhanced version</b> halogen-free	1	96.453.1050.1
	2	96.453.2050.1
	3	96.453.3050.1
	4	96.453.4050.1
	5	96.453.5050.1
	6	96.453.6050.1
	7	96.453.7050.1
	8	96.453.8050.1

### Connection cables female – free end

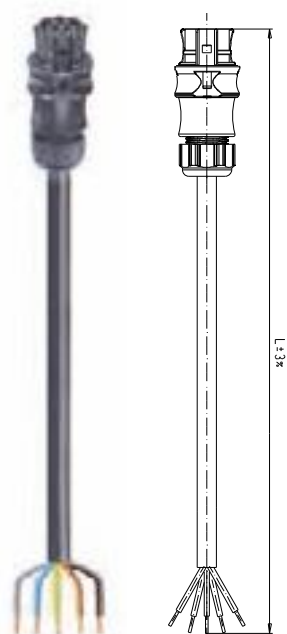

Power  
250V / 400V



Power 250V  
+ Dimming



Cable	Length m	Part No.	Part No.
<b>PVC cable H05VV-F</b> containing halogen	1	96.453.1003.1	96.453.1003.6
	2	96.453.2003.1	96.453.2003.6
	3	96.453.3003.1	96.453.3003.6
	4	96.453.4003.1	96.453.4003.6
	5	96.453.5003.1	96.453.5003.6
	6	96.453.6003.1	96.453.6003.6
	7	96.453.7003.1	96.453.7003.6
	8	96.453.8003.1	96.453.8003.6

Cable	Length m	Part No.	Part No.
<b>Rubber-sheathed cable H07RN-F</b> containing halogen	1	96.453.1033.1	96.453.1033.6
	2	96.453.2033.1	96.453.2033.6
	3	96.453.3033.1	96.453.3033.6
	4	96.453.4033.1	96.453.4033.6
	5	96.453.5033.1	96.453.5033.6
	6	96.453.6033.1	96.453.6033.6
	7	96.453.7033.1	96.453.7033.6
	8	96.453.8033.1	96.453.8033.6

Cable	Length m	Part No.
<b>Rubber-sheathed cable H07RN-F enhanced version</b> halogen-free	1	96.453.1053.1
	2	96.453.2053.1
	3	96.453.3053.1
	4	96.453.4053.1
	5	96.453.5053.1
	6	96.453.6053.1
	7	96.453.7053.1
	8	96.453.8053.1

Other cable lengths, other codings upon request

# Cable assemblies

## Cable 5 x 2.5 mm<sup>2</sup>; 20 A

Connection cables male – free end

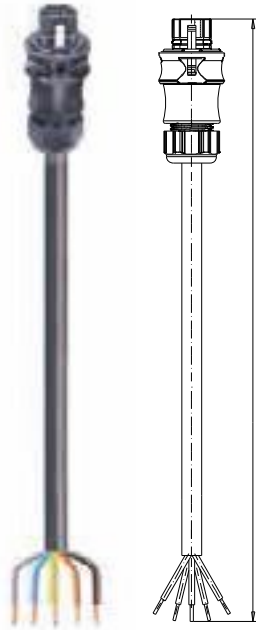

Power  
250V / 400V



Power 250V  
+ Dimming



Cable	Length m	Part No.	Part No.
<b>PVC cable H05VV-F</b> containing halogen	1	96.453.1004.1	96.453.1004.6
	2	96.453.2004.1	96.453.2004.6
	3	96.453.3004.1	96.453.3004.6
	4	96.453.4004.1	96.453.4004.6
	5	96.453.5004.1	96.453.5004.6
	6	96.453.6004.1	96.453.6004.6
	7	96.453.7004.1	96.453.7004.6
	8	96.453.8004.1	96.453.8004.6

Cable	Length m	Part No.	Part No.
<b>Rubber-sheathed cable H07RN-F</b> containing halogen	1	96.453.1034.1	96.453.1034.6
	2	96.453.2034.1	96.453.2034.6
	3	96.453.3034.1	96.453.3034.6
	4	96.453.4034.1	96.453.4034.6
	5	96.453.5034.1	96.453.5034.6
	6	96.453.6034.1	96.453.6034.6
	7	96.453.7034.1	96.453.7034.6
	8	96.453.8034.1	96.453.8034.6

Cable	Length m	Part No.
<b>Rubber-sheathed cable H07RN-F enhanced version</b> halogen-free	1	96.453.1054.1
	2	96.453.2054.1
	3	96.453.3054.1
	4	96.453.4054.1
	5	96.453.5054.1
	6	96.453.6054.1
	7	96.453.7054.1
	8	96.453.8054.1



# Cable assemblies

## Cable 5 x 2.5 mm<sup>2</sup>; 20 A (Power 5-pole)

Rated values		
Wire ends	(open cable end)	ultrason. welded
Sheath strip length	(open cable end)	35 mm
Wire strip length	(open cable end)	9 mm

Connection type cable	Cable gland
Lockable	yes, loosening with screw driver
Color cable	gray
Color handle shell	black

### Connection cables female – male

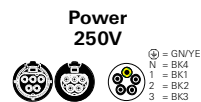
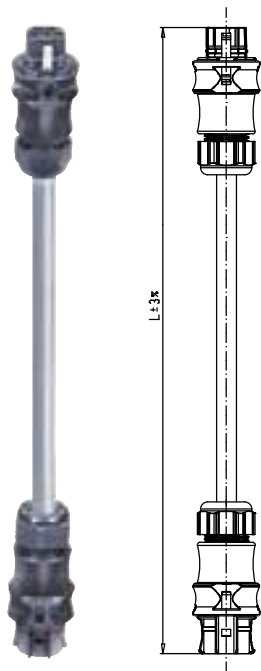

Cable	Length m	Part No.
<b>Cable Ölflex Classic 110</b> containing halogen	1	96.453.1080.1
	2	96.453.2080.1
	3	96.453.3080.1
	4	96.453.4080.1
	5	96.453.5080.1
	6	96.453.6080.1
	7	96.453.7080.1
	8	96.453.8080.1

### Connection cables female – free end

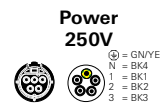
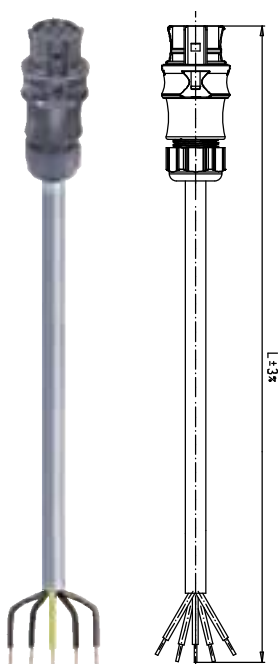

Cable	Length m	Part No.
<b>Cable Ölflex Classic 110</b> containing halogen	1	96.453.1080.1
	2	96.453.2080.1
	3	96.453.3080.1
	4	96.453.4080.1
	5	96.453.5080.1
	6	96.453.6080.1
	7	96.453.7080.1
	8	96.453.8080.1

# Cable assemblies

## Cable 5 x 2.5 mm<sup>2</sup>; 20 A (Power 5-pole)

Connection cables male – free end

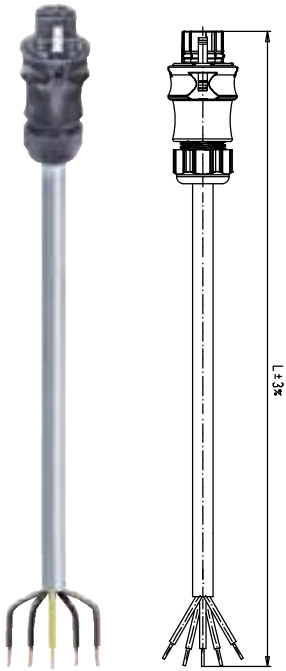

Power  
250V



Cable	Length m	Part No.
<b>Cable</b> <b>Ölflex Classic 110</b> containing halogen	1	96.453.1080.1
	2	96.453.2080.1
	3	96.453.3080.1
	4	96.453.4080.1
	5	96.453.5080.1
	6	96.453.6080.1
	7	96.453.7080.1
	8	96.453.8080.1

# Cable assemblies

## Cable 5 x 4.0 mm<sup>2</sup>; 20 A

Rated values		
Wire ends	(open cable end)	ultrason. welded
Sheath strip length	(open cable end)	35 mm
Wire strip length	(open cable end)	9 mm

Connection type cable	Cable gland
Lockable	yes, loosening with screw driver
Color cable	black
Color handle shell	black

### Connection cables female – male

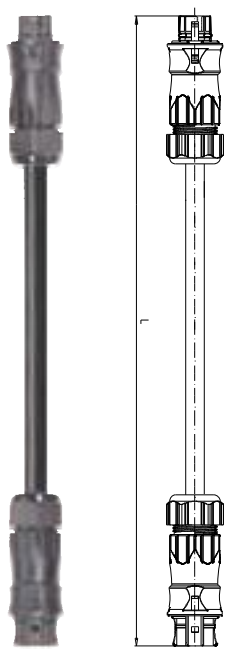

Cable	Length m	Part No.	Part No.
<b>PVC cable H05VV-F</b> containing halogen	1	96.454.1000.1	96.454.1000.6
	2	96.454.2000.1	96.454.2000.6
	3	96.454.3000.1	96.454.3000.6
	4	96.454.4000.1	96.454.4000.6
	5	96.454.5000.1	96.454.5000.6
	6	96.454.6000.1	96.454.6000.6
	7	96.454.7000.1	96.454.7000.6
	8	96.454.8000.1	96.454.8000.6

Cable	Length m	Part No.	Part No.
<b>Rubber-sheathed cable H07RN-F</b> containing halogen	1	96.454.1030.1	96.454.1031.6
	2	96.454.2030.1	96.454.2031.6
	3	96.454.3030.1	96.454.3031.6
	4	96.454.4030.1	96.454.4031.6
	5	96.454.5030.1	96.454.5031.6
	6	96.454.6030.1	96.454.6031.6
	7	96.454.7030.1	96.454.7031.6
	8	96.454.8030.1	96.454.8031.6

### Connection cables female – free end

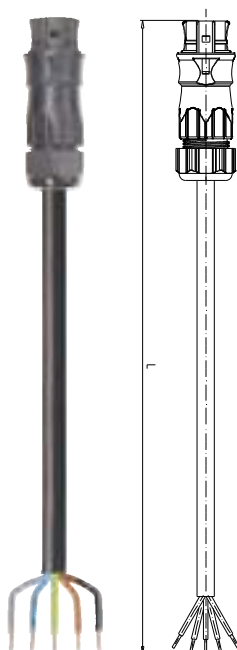

Cable	Length m	Part No.	Part No.
<b>PVC cable H05VV-F</b> containing halogen	1	96.454.1003.1	96.454.1003.6
	2	96.454.2003.1	96.454.2003.6
	3	96.454.3003.1	96.454.3003.6
	4	96.454.4003.1	96.454.4003.6
	5	96.454.5003.1	96.454.5003.6
	6	96.454.6003.1	96.454.6003.6
	7	96.454.7003.1	96.454.7003.6
	8	96.454.8003.1	96.454.8003.6

Cable	Length m	Part No.	Part No.
<b>Rubber-sheathed cable H07RN-F</b> containing halogen	1	96.454.1033.1	96.454.1033.6
	2	96.454.2033.1	96.454.2033.6
	3	96.454.3033.1	96.454.3033.6
	4	96.454.4033.1	96.454.4033.6
	5	96.454.5033.1	96.454.5033.6
	6	96.454.6033.1	96.454.6033.6
	7	96.454.7033.1	96.454.7033.6
	8	96.454.8033.1	96.454.8033.6

Other cable lengths, other codings upon request

# Cable assemblies

## Cable 5 x 4.0 mm<sup>2</sup>; 20 A

### Connection cables male – free end

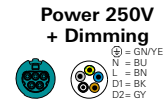
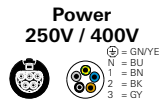
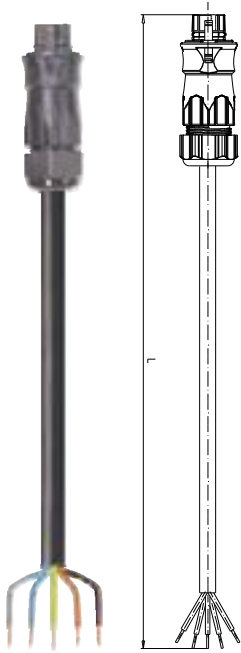

Cable	Length m	Part No.	Part No.
<b>PVC cable H05VV-F</b> containing halogen	1	96.454.1004.1	96.454.1004.6
	2	96.454.2004.1	96.454.2004.6
	3	96.454.3004.1	96.454.3004.6
	4	96.454.4004.1	96.454.4004.6
	5	96.454.5004.1	96.454.5004.6
	6	96.454.6004.1	96.454.6004.6
	7	96.454.7004.1	96.454.7004.6
	8	96.454.8004.1	96.454.8004.6

Cable	Length m	Part No.	Part No.
<b>Rubber-sheathed cable H07RN-F</b> containing halogen	1	96.453.1034.1	96.453.1034.6
	2	96.453.2034.1	96.453.2034.6
	3	96.453.3034.1	96.453.3034.6
	4	96.453.4034.1	96.453.4034.6
	5	96.453.5034.1	96.453.5034.6
	6	96.453.6034.1	96.453.6034.6
	7	96.453.7034.1	96.453.7034.6
	8	96.453.8034.1	96.453.8034.6

## Distribution units

**RST compact distribution unit**



Name	Color	Part No.
<b>Distribution unit 5-pole</b>	gray	on request
	black	96.050.0153.1

**Detailed information about the distribution units available in section "Distribution units".**

Dimensions (W x L x H)	104 x 162 x 57.2 mm
Input	1
Outputs	3
3 Outputs Weiterleit. 230/400V, 20A	RST 20i5 coding Color black
Prewired with	2.5 mm <sup>2</sup>
Fastening options	yes

Circuit diagram

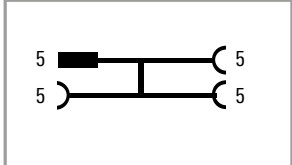

**RST multi-distribution unit**





Name	Color	Part No.
<b>RST multi-distribution unit 1 Input / 5 Outputs</b>	black	on request
		96.050.2153.1

**Detailed information about the distribution units available in section "Distribution units".**

Dimensions (W x L x H)	104 x 162 x 96 mm
Fitted as required with	M25 device connectors 2 – 5-pole
Input	1
Outputs	7
Prewired with	2.5 mm <sup>2</sup>
Fuses	6.3 or 10 A can be integrated

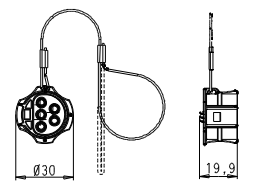

## Accessories – Cover pieces

**Female connector 4 to 5-pole**

not captive against loss		captive against loss	
Pole	4 – 5-pole	Pole	4 – 5-pole
Safe locking	unused male connectors	Safe locking	unused male connectors
Color	Part No.	Color	Part No.
light gray	05.565.9953.0	light gray	99.531.0000.7
black	05.565.9953.1	black	99.532.0000.7

**Male connector 4 to 5-pole**

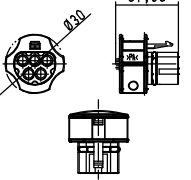
not captive against loss		captive against loss	
Pole	4 – 5-pole	Pole	4 – 5-pole
Safe locking	unused female connectors	Safe locking	unused female connectors
Color	Part No.	Color	Part No.
light gray	Z5.565.9853.0	light gray	99.529.0000.7
black	Z5.565.9853.1	black	99.530.0000.7

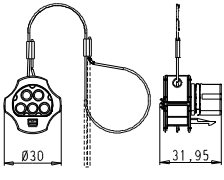
## Accessories Crimp

<b>Female contacts</b> for connectors RST20i5	Name	Marking (groove) mm <sup>2</sup>		Part No.	Units per pack
	<b>Crimp contact</b>	unmarked	0.75 – 1.0	02.125.5521.8	100
	<b>Crimp contact</b>	1	1.5	02.125.5621.8	100
	<b>Crimp contact</b>	2	2.5	02.125.5721.8	100
	<b>Crimp contact</b>	3	4.0	02.125.5821.8	100



\* Available on straps or in magazines on request

<b>Male contacts</b> for connectors RST20i5	Name	Marking (groove) mm <sup>2</sup>		Part No.	Units per pack
	<b>Crimp contact</b>	unmarked	0.75 – 1.0	05.545.0021.8	100
	<b>Crimp contact</b>	1	1.5	05.545.0121.8	100
	<b>Crimp contact</b>	2	2.5	05.545.0221.8	100
	<b>Crimp contact</b>	3	4.0	05.545.0321.8	100



\* Available on straps or in magazines on request

<b>Crimping tool</b>	Name	Part No.
	<b>Crimping tool incl. system kit</b>	95.101.0800.0
	<b>Crimping die B</b>	05.502.2100.0
	<b>Contact positioner</b>	05.502.3600.0



<b>Unlocking tool</b> for crimp contacts	Name	Part No.
	<b>Unlocking tool</b>	05.502.3500.0

